

FIXED JOINT



ORBITAL JOINT



SPHERICAL JOINT



Crossover on Board	
Speaker Type:	3,5" Wide Band
Nominal Impedence	8Ω
Crossover	HP=200 Hz; 12 dB/oct
Frequency Range	200-20.000Hz (-6dB)
Sensitivity (1W - 1m)	86dB
Speaker Peak Power	70W
Speaker RMS Power	50W
High-z on Board	Optional (Voltage 70-100 V; Power 10 W)
Lighting Mood	N/A
Body Materials	Concrete (gray, black, white, red) Marble, travertine and alternative stones
Metal Components Materials	Stainless steel 304 (polished, satin, painted matt black) Stainless steel 316L, Oxidized Brass
Weight	3.5 Kg (7.7 pounds)

FIXED JOINT

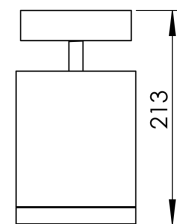
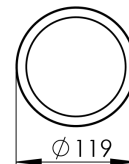
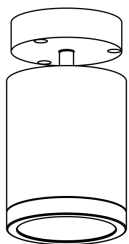

ORBITAL JOINT

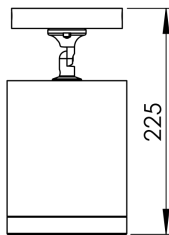
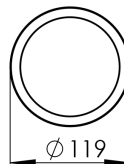
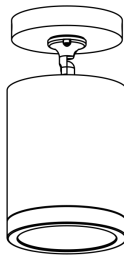

SPHERICAL JOINT

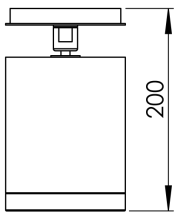
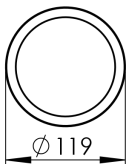
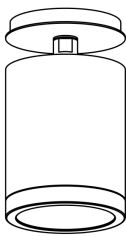

Orientation		
0°	+/- 45°	+/- 20°

Unpacking: to remove Icarus_wall from the shipping box carefully follow these steps

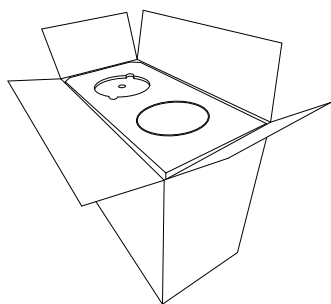

1. Icarus_wall is shipped in a box secured with packing foam; the box has been designed to contain up to two sound modules.

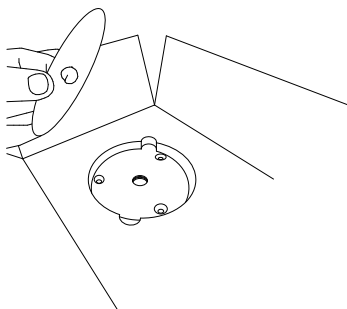

2. Only for SPHERICAL version:
Remove the metal finishing disc and the metal plate with holes and set them aside.

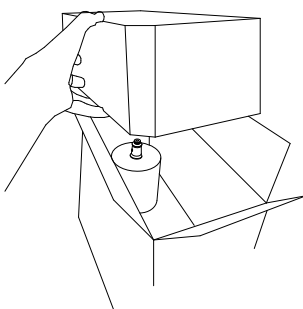

3. Remove the upper part of the foam to release the sound module.

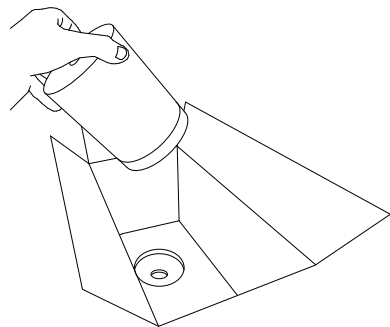

4. Holding gently the module pull it out of the box ready for set-up and installation.

INSTALLATION

for Icarus_Wall FIXED and SPHERICAL versions

Both Icarus_Wall Fixed or Spherical joint versions follow the same installation process, for they only differ in having the metal disc in front of the wall plate or not.

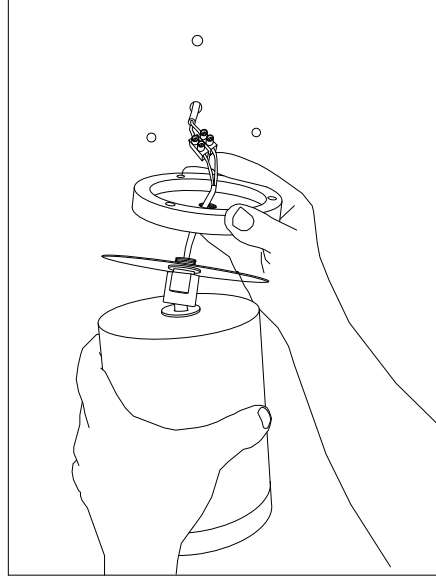
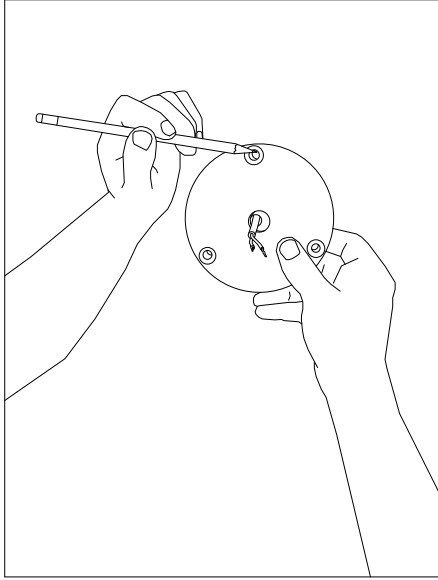

Installing Icarus_Wall requires two people, especially during the cable connection phase.

Align the central hole of the metal plate with the hole in the wall where the audio cable comes out and using the plate as a template mark the three holes with a pencil. Proceed to drill the holes and insert into them the expansion wall plugs you will need to secure the metal plate in the wall.

Connect the sound module cable to the cable coming out from the wall using a cable connector. The part of the cable with the connector will then be housed in the space provided behind the metal plate, so that the connection remains hidden towards the wall (see section next page).

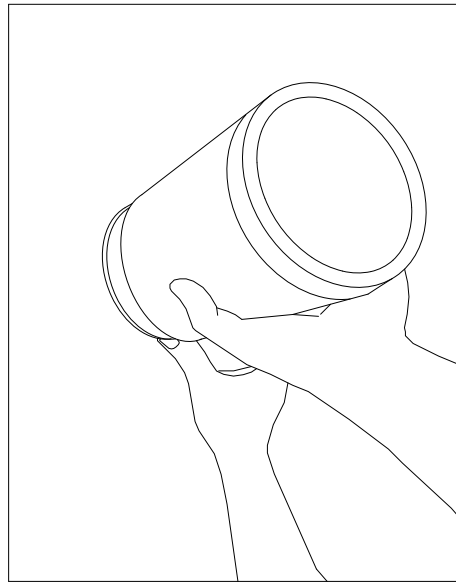
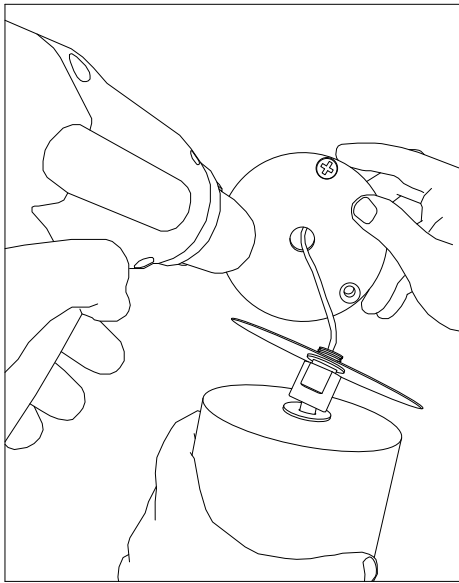

Fix the plate to the wall by tightening the screws into the expansion wall plugs.

Now you can screw the Icarus_Wall's threaded end of the metal joint to the metal plate on the wall.

For the SPHERICAL VERSION:
The metal disc will cover the heads of the screws

Place Icarus_Wall in the desired position by moving it around its Spherical joint, after loosening the mechanics with a 20-mm wrench; tighten it back to hold desired position.

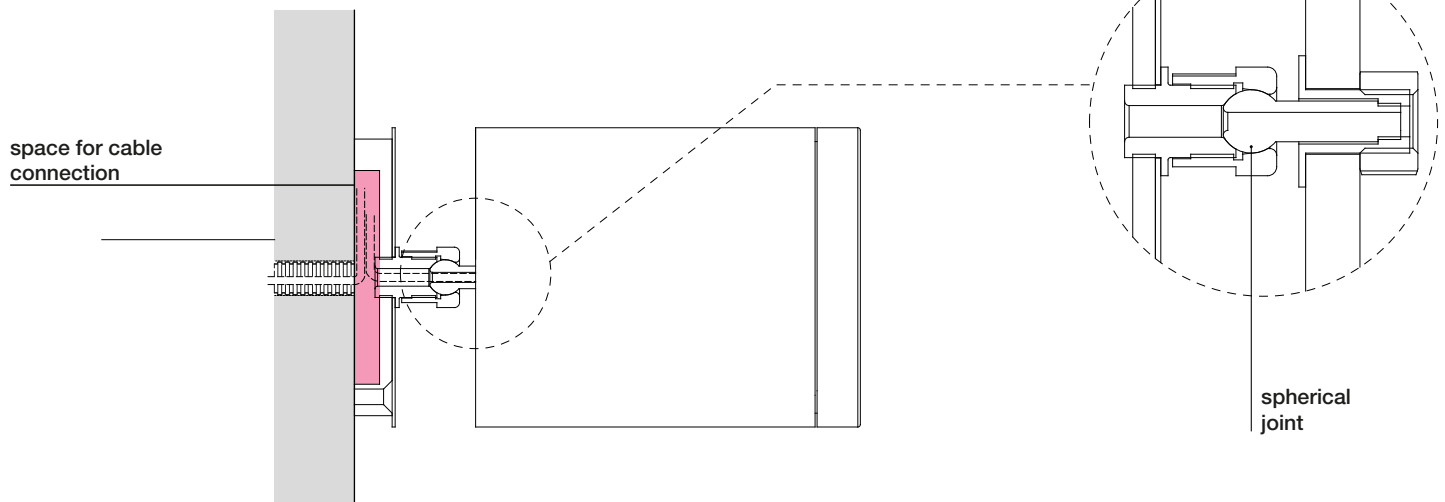

INSTALLATION PROCESS

for Icarus_Wall ORBITAL versions

Two people are needed to install Icarus_Wall ORBITAL version too, especially in the cable connection phase. Before proceeding, please recover anchors (wall plugs) suitable for your hanging surface, for the anchor changes according to the wall material (concrete, plasterboard, wood...)

1.

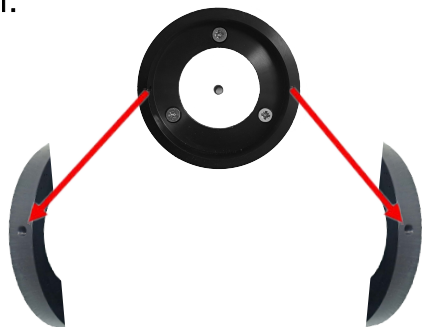

First, make sure that the central large hole of the wall plate matches with the hole in the wall where the audio cables come out, and that the 2 side-holes of the wall plate are horizontally aligned.

Now you can fix the disc to the wall by tightening the screws into the expansion wall plugs.

2.



While a person holds Icarus_Wall, the second person can proceed with connecting it to the cables coming out from the wall, always bearing in mind the colors of the polarities.

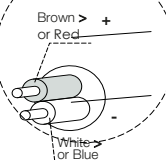

3.

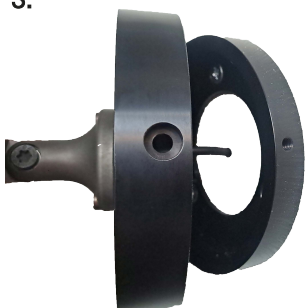

These cables then will be housed in the space provided behind the front plate, so that the connection remains hidden towards the wall.

4.

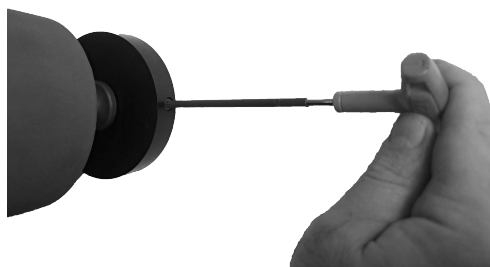

Lock the plate to the wall by tightening the two M5 Torx screws (supplied)

5.

At this stage, you need to adjust the rotation and then the inclination of the Icarus_Wall satellite.

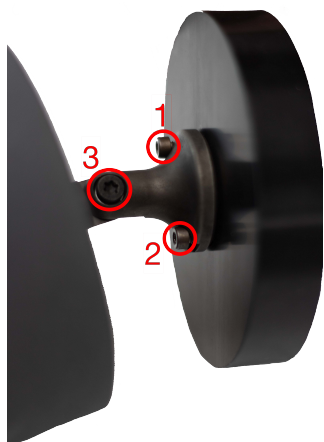

in order to do this, first loosen the screws at the base of the orbital joint.

(screws #1 & #2 in this picture).

6.



Now adjust the rotation according to your needs,

then tighten both screws (#1 and #2 in the previous picture)

7.

Now you have to loosen screw #3 to adjust the inclination of the entire satellite. Once adjusted, tighten the screw.

8.

Now the installation of Icarus_Wall in its Orbital-Joint version can be considered accomplished.

Acoustic connectivity and settings: Featuring a crossover on board, Icarus_Wall only requires a bipolar cable coming from the amplifier handling the proper power (see tech specs above). Using a DSP is recommended (but not mandatory) for suitable acoustic fine tuning.

Maintenance and care: In order to keep your speakers beautiful as long as possible, we warmly recommend doing maintenance at least once a year. When not in use, sound modules should be appropriately covered or stored away; heavy duty protective covers are available from AS. Please refer to the General Manual for appropriate instructions and note that any departure from our recommendations on care and cleaning, or any evidence of misuse or damages from ordinary wear and tear, will void all warranty claims.



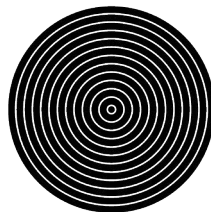

CRAFTED BY SOUND